

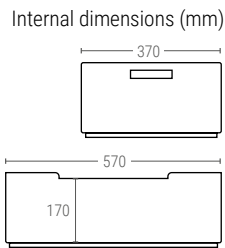

1796

PERFORATED CONTAINER WITH OPEN HANDLES

Ext. dimensions	L.600; W.400; h.200 mm
Weight	1,750 kg
Capacity	40 liter
Color	○ ○
Material	HDPE
Units per pallet	48



1796P

CONTAINER WITH PERFORATED WALLS AND SOLID BASE, OPEN HANDLES

Ext. dimensions	L.600; W.400; h.200 mm
Weight	2,000 kg
Capacity	40 liter
Color	○ ○
Material	HDPE
Units per pallet	48

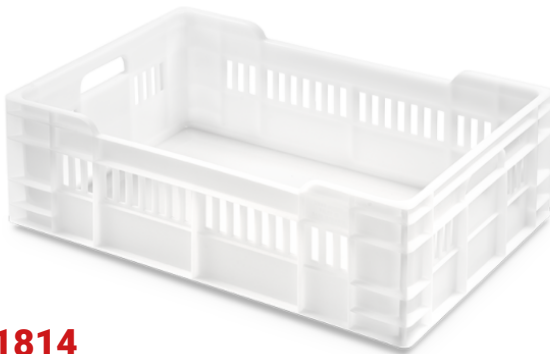
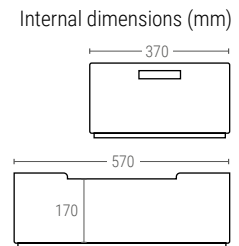

1814

CONTAINER WITH HALF PERFORATED WALLS AND SOLID BASE, OPEN HANDLES

Ext. dimensions	L.600; W.400; h.200 mm
Weight	2,175 kg
Capacity	40 liter
Color	○ ○
Material	HDPE
Units per pallet	48

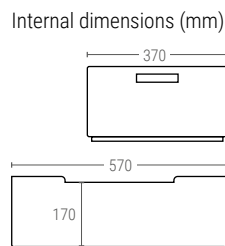

1816

SOLID CONTAINER WITH OPEN HANDLES

Ext. dimensions	L.600; W.400; h.200 mm
Weight	2,200 kg
Capacity	40 liter
Color	○ ○
Material	HDPE
Units per pallet	48

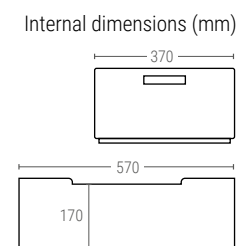

SUITABLE BASE FOR USE IN AUTOMATED CONVEYOR SYSTEMS



➤ Solid base

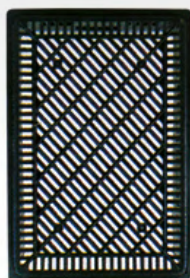

➤ Perforated base